



**Location**

145 Hobsons Lake Drive, Halifax, NS

**Year Built**

2015

**Availability**

Commercial/Office space available now

**Parking**

On-site parking

**Lease Rate**

\$12/sf net

**Tenants**

PWSGC – CRA  
Armco Capital Inc.  
Hobsons Lake Café

**Building Size**

134,000 sf

Located in Bayers Lake Business Park, this new construction office building offers on-site parking and quick access to both Highways 102 & 103. As of July 2016 the building has been **Certified LEED GOLD**. The project is adjacent to the Chain of Lakes trail system and is surrounded by all of Bayers Lake’s amenities. This is part of a masterplan to create a micro community within the next 2 - 4 years with residential, office/retail, and service retail abutting Highway 103.

The Bayer’s Lake Business park is one of the major concentrations of commercial activity in the Greater Halifax area. The Park is home to major retail “super stores”, as well as warehousing operations and office space.

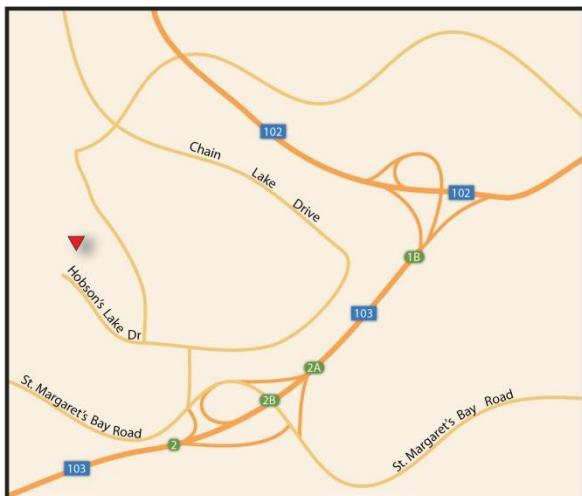

**Building Amenities**

- **LEED Gold Certified-July, 2016**
- Carpool parking
- On-site showers
- Adjacent to Chain of Lakes Trails
- Located on two major Halifax Transit Routes – 21 & 52
- Hobsons Lake Café





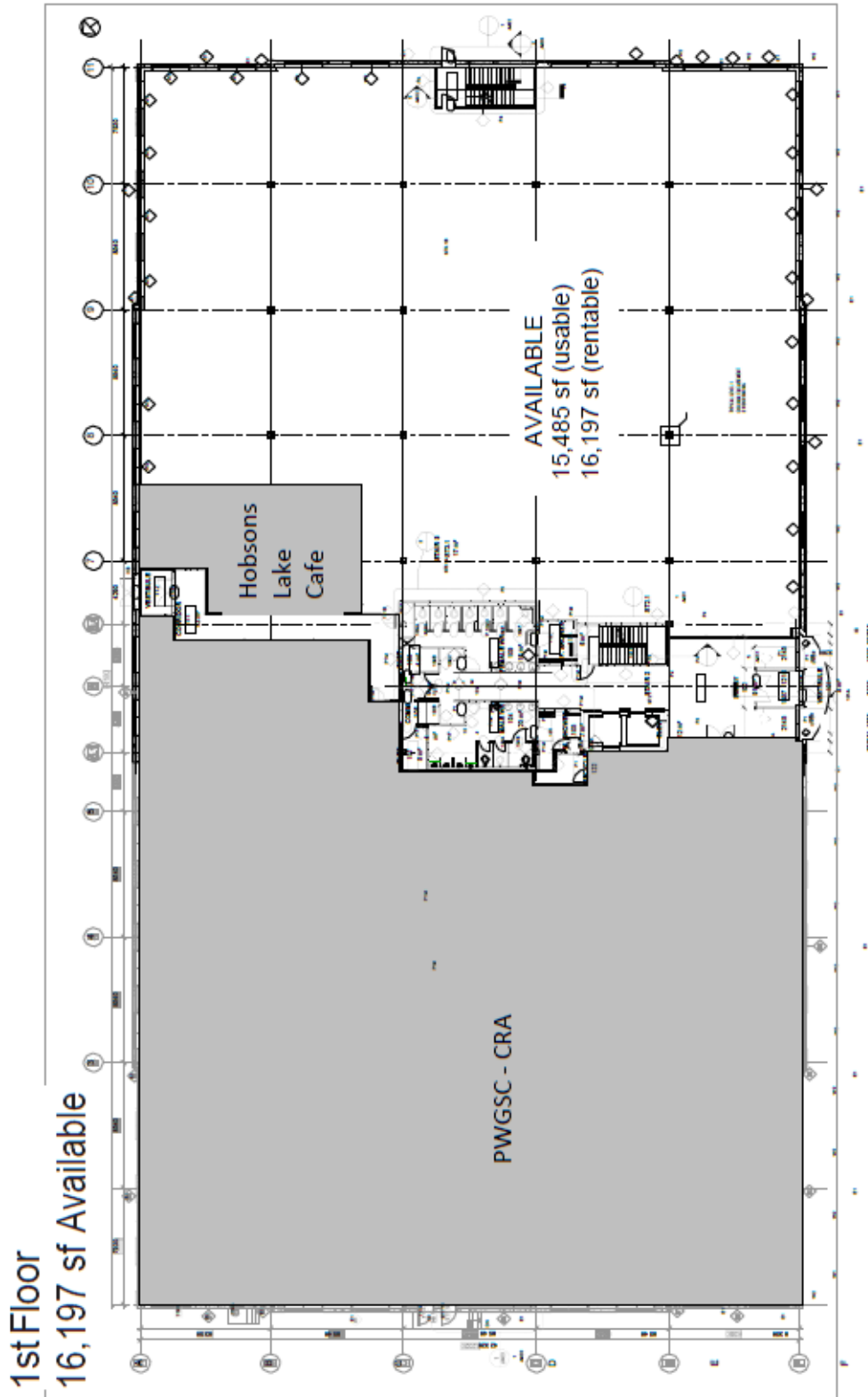

**1st Floor**  
**16,197 sf Available**

